

INSTALLATION INSTRUCTIONS



ELECTRICAL SHOCK HAZARD

READ, UNDERSTAND, and FOLLOW these instructions before installing the equipment.

WARNING

Disconnect the Electrical supply power at the service panel (fuse or circuit breaker box). Failure to do so could result in serious injury or death. Only qualified electricians should install this fixture and the installation **MUST** conform to the Electrical Code and all local codes and ordinances. Ensure that only proper tools, materials, and equipment are used to complete the installation.

SAFETY

- Proper grounding is required to ensure personal safety.
- Fixture should be mounted in locations where unauthorized personnel will not readily subject it to tampering.
- Do not use this equipment for anything other than its intended purpose.
- Servicing this equipment should be performed by qualified service personnel.
- Save these instructions.
- **MIN 90 °C SUPPLY CONDUCTOR**

TOOLS REQUIRED

- TT27 Screwdriver
- Wrench

INSTALLATION

1. Use the provided template to preinstall 4 anchor bolts.

Install the anchor bolts in concrete, with at least 1-1/2 ~2" protruding from concrete with threads free and clear of debris and dirt.

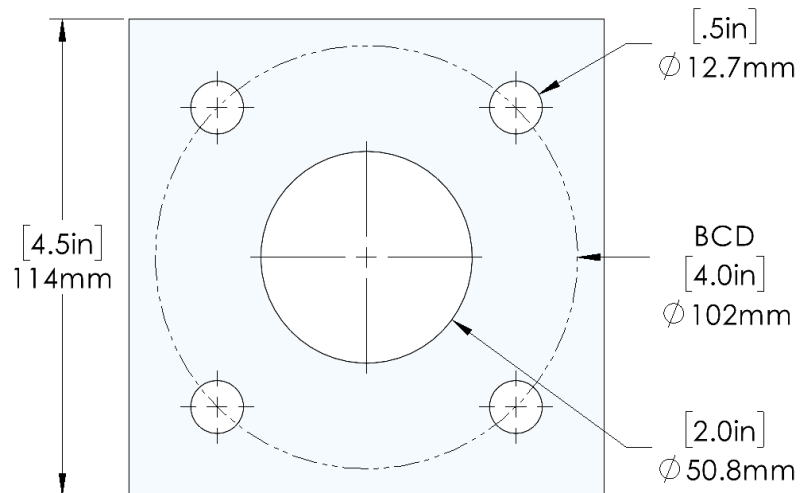

Image for reference only.

2. Attach a nut and washer to each anchor bolt.



INSTALLATION INSTRUCTIONS

3. Release the base by removing the 4 base tamper proof mounting screws with a TT27 screwdriver.
4. Install the base by sliding it over the anchor bolts, ensuring the wiring passes through the middle. Secure the base with washers and nuts, and use the nuts to ensure the base is horizontal.
5. Run the AC wires through the strain relief.
6. Run the line wires through the NM cable connector and secure the 2 screws on the connector.
7. Use a 3 wire closed end connector (must be waterproof and UL approved) to connect the AC wires inside the fixture. Fold and secure the wires around the driver bracket with a cable tie at a minimum distance of 12" above the base.
8. Slide the body of the bollard over the base.
9. Reattach the body by reinstalling the 4 base mounting screws.

WATTAGE & CCT SWITCH

Wattage and CCT switch is included. It can be accessed on the bottom of the driver bracket during installation.

- Lumens/Power can be set to 15W, 20W or 25W.
- CCT can be set to 3000K, 4000K or 5000K.
- Default settings: 20W and 4000K.

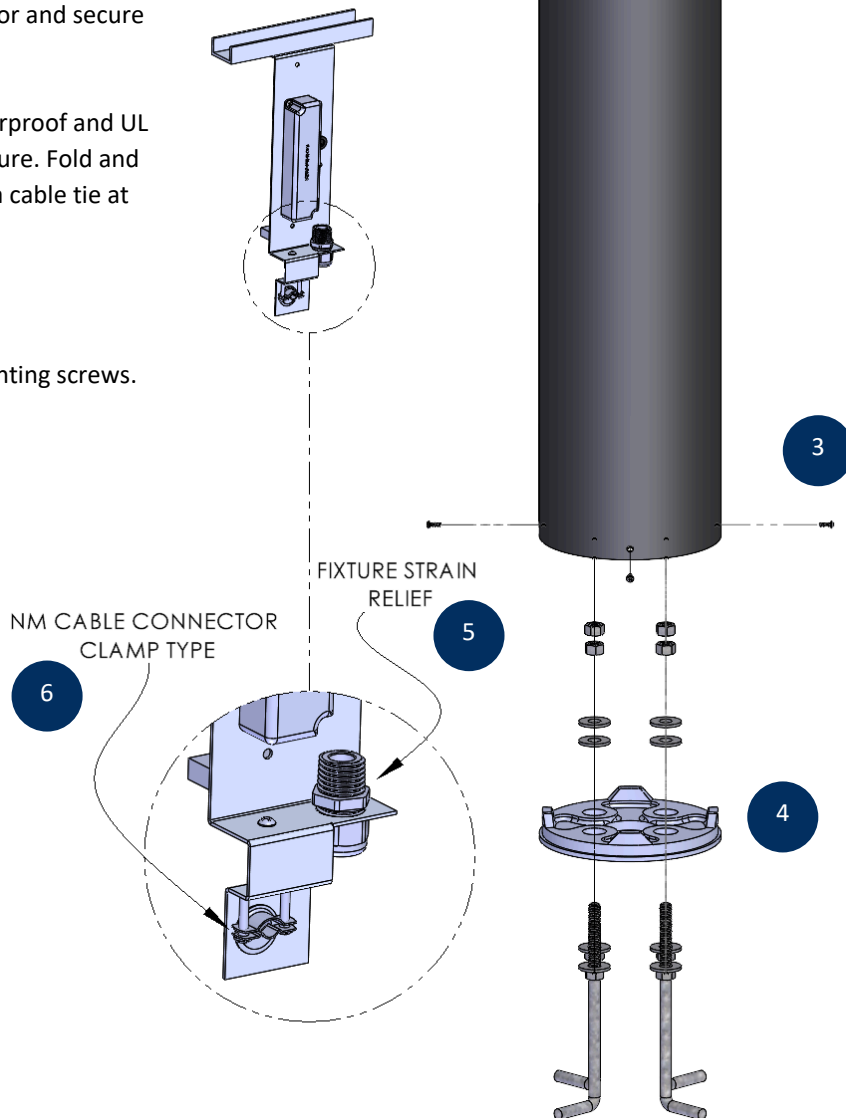
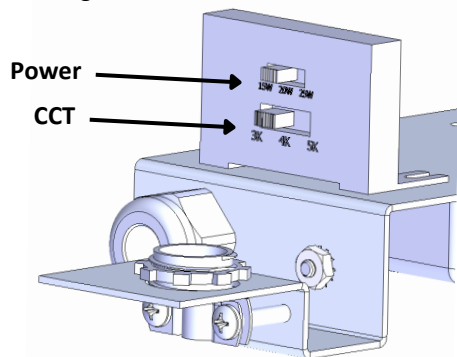

WIRING

- Check that the line voltage is correct.
- Connect fixture **GROUND** (green) wire to power supply **GROUND** (green) wire.
- Connect fixture **WHITE** wire to power supply **NEUTRAL** wire.
- Connect fixture **BLACK** wire to power supply **LINE** wire
- The fixture includes 0-10V dimming functionality, connect GREY or PINK and VIOLET wires to a 0-10V dimming controller (optional).

SUPPLY	HOT	BLACK	LIGHT FIXTURE
	NEUTRAL	WHITE	
	GROUND	GREEN	
0-10V DIM		GREY OR PINK	
		VIOLET	