

**INSTALLATION INSTRUCTIONS**



**ELECTRICAL SHOCK HAZARD**

**READ, UNDERSTAND, and FOLLOW** these instructions before installing the equipment.

**WARNING**

Disconnect the Electrical supply power at the service panel (fuse or circuit breaker box). Failure to do so could result in serious injury or death. Only qualified electricians should install this fixture and the installation **MUST** conform to the Electrical Code and all local codes and ordinances. Ensure that only proper tools, materials, and equipment are used to complete the installation.

**SAFETY**

- Proper grounding is required to ensure personal safety.
- Fixture should be mounted in locations where unauthorized personnel will not readily subject it to tampering.
- Do not use this equipment for anything other than its intended purpose.
- Servicing this equipment should be performed by qualified service personnel.
- Save these instructions.
- This equipment has been tested and found to comply with the limits for a Class B digital device, pursuant to part 15 of the FCC Rules. These limits are designed to provide reasonable protection against harmful interference in a residential installation. This equipment generates, uses and can radiate radio frequency energy and, if not installed and used in accordance with the instructions, may cause harmful interference to radio communications.
- Changes or modifications to this unit not expressly approved by the party responsible for compliance Could void the user authority to operate the equipment.
- **MIN 90 °C SUPPLY CONDUCTOR**

**INSTALLATION**

**Tools Required:**

- Screwdriver and Drilling tools.

**Wall Mount**

- Open the fixture by loosening the screw at the bottom of the fixture. [1]
- Attach the gasket to the back of the rear housing. [2]
- Prepare the rear housing for installation by drilling the appropriate holes. [3]
- Mount the rear housing at desired location using the appropriate screws. Ensure that the top, both sides and the mounting holes that are touching the wall are sealed with silicone.
- Hang the front housing on to the anti-drop screw attached on the rear housing and make appropriate wiring connections as per wiring diagram. [4]
- Hook the front housing back to the rear housing. [5]
- Close the front housing and tighten the bottom screw.

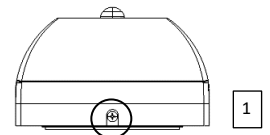

1

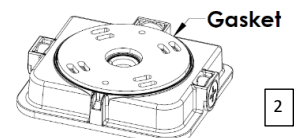

2

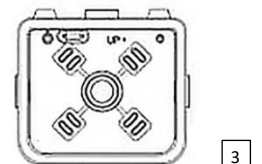

3

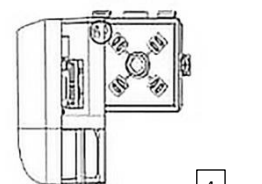

4

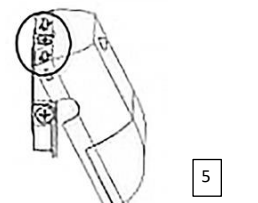

5

**INSTALLATION INSTRUCTIONS****CCT SELECTABLE SWITCH**

- CCT selectable switch is accessed inside the fixture housing. Can be set at 3000K/4000K/5000K CCT.

**Note:**

- Photocell can be disconnected by cutting and capping (separately) the wires connected to photocell.

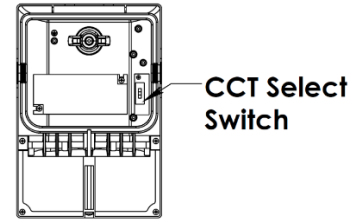
**WIRING**

- Check that the line voltage is correct.
- Connect fixture **GROUND** (green) wire to power supply **GROUND** (green) wire.
- Connect fixture **WHITE** wire to power supply **NEUTRAL** wire.
- Connect fixture **BLACK** wire to power supply **LINE** wire.
- The fixture includes 0-10V dimming functionality, connect **GREY** or **PINK** and **VIOLET** wires to a 0-10V dimming controller (optional).

