

# CPL-LED BACKLIT PANELS



## INSTALLATION INSTRUCTIONS



### ELECTRICAL SHOCK HAZARD

**READ, UNDERSTAND, and FOLLOW** these instructions before installing the equipment.

### WARNING

Disconnect the Electrical supply power at the service panel (fuse or circuit breaker box). Failure to do so could result in serious injury or death. Only qualified electricians should install this fixture and the installation MUST conform to the Electrical Code and all local codes and ordinances. Ensure that only proper tools, materials, and equipment are used to complete the installation.

### SAFETY

- Proper grounding is required to ensure personal safety.
- Fixture should be mounted in locations where unauthorized personnel will not readily subject it to tampering.
- Do not use this equipment for anything other than its intended purpose.
- Servicing this equipment should be performed by qualified service personnel.
- Save these instructions.
- This equipment has been tested and found to comply with the limits for a Class B digital device, pursuant to part 15 of the FCC Rules. These limits are designed to provide reasonable protection against harmful interference in a residential installation. This equipment generates, uses and can radiate radio frequency energy and, if not installed and used in accordance with the instructions, may cause harmful interference to radio communications.
- Changes or modifications to this unit not expressly approved by the party responsible for compliance Could void the user authority to operate the equipment.

### INSTALLATION FLUSH CEILING MOUNT

- Remove the grid tile from the ceiling.
- Lift the fixture to the ceiling and make appropriate wiring connections as per the wiring diagram.
- Optional: Adjust the Wattage/Lumen and CCT select switches as desired.
- Slide the fixture into the ceiling grid and attach the earthquake mounting clips by bending over the grid rails.

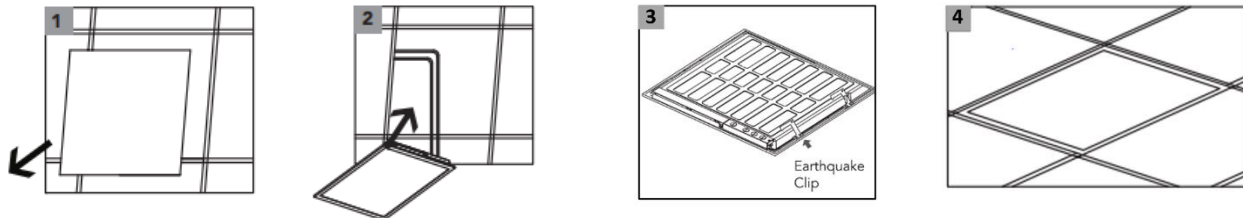

### INSTALLATION 2 CABLE PENDANT MOUNT (optional purchase of accessories)

- Drill 2 mounting holes to the ceiling, with the holes being spaced according to the size of the panel light. Use appropriate screw securing method (for given ceiling material) to secure the female part of the rope grab device to the ceiling by drilling the self tapping screw into mounting holes.
- Ensure wire is secured with male part of the rope grab device. Screw the male part of the rope grab device into the female part.
- Connect wire hooks to triangular hooks on panel light

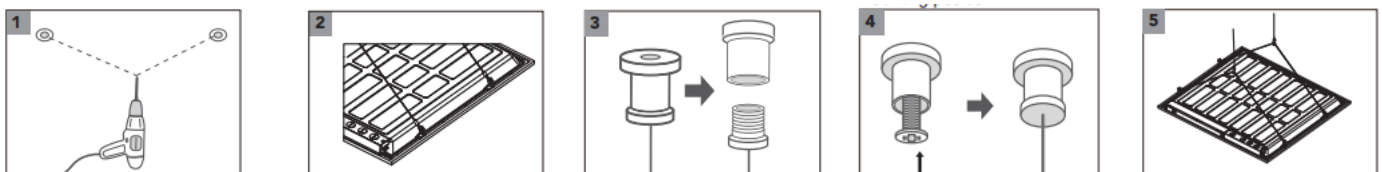

## INSTALLATION INSTRUCTIONS

### INSTALLATION SURFACE MOUNT (optional purchase of accessories)

- Assemble the four frames with smaller screw to create square the size of the panel light.
- Fix the square made of four frames to the ceiling with larger screw.
- Demount one side of the frame to make room for panel light.
- Put the panel into the square frame.
- Put the previously removed piece of frame back in place using the smaller screw.

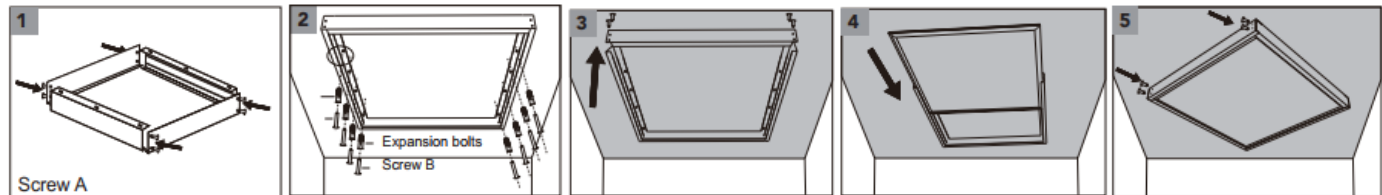

### CCT & LUMEN SELECTABLE SWITCHES

- CCT selectable switch is accessed behind the luminaire. Can switch between 3500K, 4000K, and 5000K CCT. 4000K is default.
- Lumen selectable switch is also accessed behind luminaire. Can switch the lumen intensity. Lumens vary depending on Luminaire model. Max lumen setting is default.

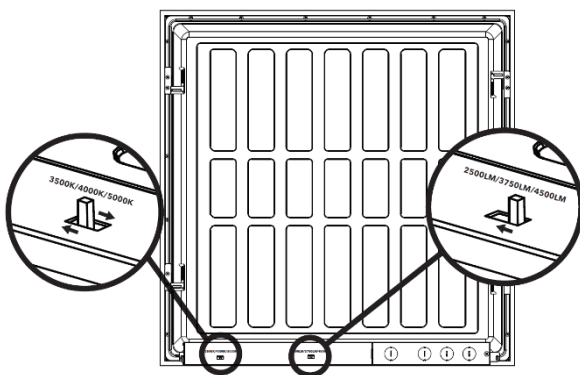

### WIRING

- Check that the line voltage is correct.
- Connect fixture **GROUND** (green) wire to power supply **GROUND** (green) wire.
- Connect fixture **WHITE** wire to power supply **NEUTRAL** wire.
- Connect fixture **BLACK** wire to power supply **LINE** wire
- The fixture includes 0-10V dimming functionality, connect **PINK** and **VIOLET** wires to the dimming controller.

