

The WRD4 is an architectural, specification grade down light with advanced optics available in custom color finishes.



### APPLICATIONS

Ideal for perimeter lighting in retail buildings, atriums, condominiums and other architectural properties.

Project	
Type	
Date	
Notes	

### SPECIFICATIONS

#### Construction

WRD4 has an extruded aluminum housing with a powder coat paint finish. The fixture has a clear tempered glass lens which is held in place with a gasket and three stainless steel screws making it approved for wet locations.

#### Mounting

The fixture can be mounted directly on to the wall with a recessed junction box and has an easy mounting system. The galvanized steel plate is attached to the wall with 4 screws. The fixture then slides under the two pins and is secured by the two set screws at the bottom.

#### Optics

The fixture has a standard color temperature of 5000K. 4000K and 3000K are available as options. The fixture also has optional diffusion lenses for narrow, medium, wide or extra wide beams.

#### Electrical

The standard unit has a high efficiency driver that operates at 120-277V.

#### Finish

Standard finish is black, bronze and white. Custom colors available.

Diameter	4.7"
Watts	14W
Lumens	1337
Efficiency	97 lumens/watt
Operating Temp	-40°C to +40°C
LED Life	100,000 hours
Color Temp.	5000K (standard), 4000K, 3000K (option)
Warranty	5 Years
Certification	Approved to uL/CSA standards

### DIMENSIONS

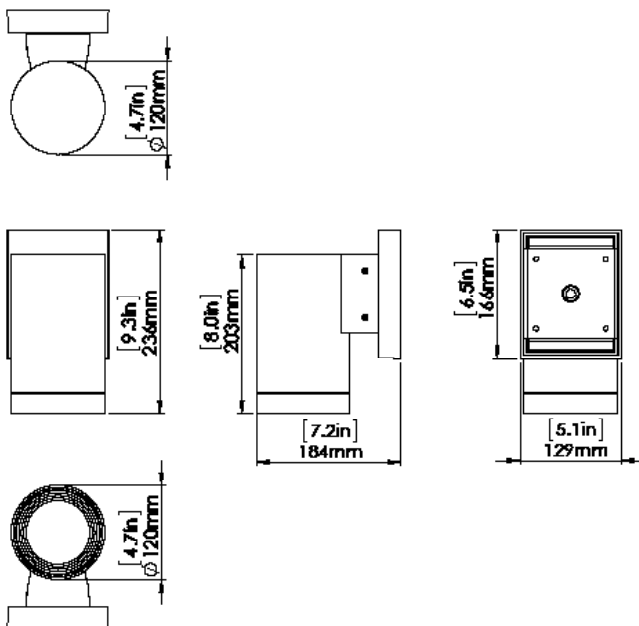

EASY INSTALLATION

Step 1: Attach steel plate on the wall with 4 screws



Step 2: Slide fixture under the two pins till it locks in



Step 3: Secure with 2 set screws on the bottom



ORDERING GUIDE

WRD4	-	LED15	-		-		-			
				VOLTAGE		COLOR TEMP.		OPTICS		FINISH
				B - 120 - 277V		3K - 3000K 4K - 4000K 5K - 5000K		N - 20° NARROW M - 33° MEDIUM W - 46° WIDE X - 94° EXTRA WIDE		WH - WHITE BLK - BLACK BRZ - BRONZE CC - CUSTOM COLOR

\* Standard configuration