

The WL-LED26 is an energy efficient wall light for outdoor use that replaces up to a 70W HPS fixture.



APPLICATIONS

Ideal for a variety of outdoor applications such as entrances, walkways and exit doors.

Project	
Type	
Date	
Notes	

SPECIFICATIONS

Construction

Durable polycarbonate housing and lens to withstand harsh weather conditions. The WL-LED26 has a cast aluminum backplate and two conduit entries; one on the back and one at the bottom.

LED Configuration

The fixture contains one high LED board that delivers a total lumen output of 2,808 lumens at an efficacy of 117 lumens/watt. This serves as an ideal replacement for a 70W HPS fixture. LEDs have a color temperature of 5000K as standard.

Electrical

Total system wattage of the unit is 24.06W. The standard unit has a high efficiency driver that operates at 120 - 277V.

Photocell

Photocell is included.

Finish

Bronze

Fixture Watts	24.06
Lumens	2,808
Efficacy	117 lumens/watt

Certifications	ETL, DLC
Rated Life	100,000 hours
Color Temperature	5000K (standard),
Warranty	5 Years
Operating temperature	-40° C to +40° C
Power Factor	0.9
CRI	>70
Total Harmonic Distortion	19.25%

DIMENSIONS

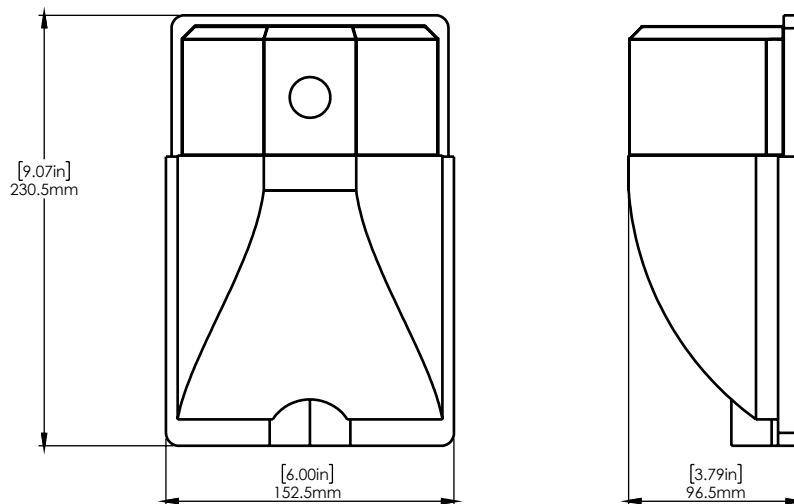

ORDERING GUIDE

WL	-	LED26	-	B	-	5K	-	BRZ	-	PC	-	CL
				VOLTAGE		COLOR TEMP		FINISH		PHOTOCELL		LENS
				B - 120 - 277V*		5K - 5000K*		BRZ - BRONZE*		PC - PHOTOCELL*		CL - CLEAR LENS*

* Standard configuration